

**HOLY CROSS CEMETERY**  
 ARRON, OHIO  
**EAST PART**  
**SECTION 22**  
 SCALE: 1"=20'  
 JAN. 5, 1978

NOTE:  
 THE LOT NUMBER IS PLACED IN THE UPPER LEFT  
 HAND CORNER OF LOTS AS YOU FACE THE LOTS AND  
 IS INDICATED THUS: [Diagram showing a lot with the number in the upper left corner]

LOCATION OF GRAVE MARKERS SHOWN THUS: [Diagram showing a grave marker symbol]

ARROW INDICATES DIRECTION GRAVE MARKERS  
 WILL FACE.

ALL LOTS ARE 2 GRAVE LOTS EXCEPT WHERE  
 OTHERWISE NOTED.

ALL 2 GRAVE LOTS ARE 6' X 9'  
 ALL 3 GRAVE LOTS ARE 9' X 9'

LOT SUMMARY  
 1290 2 GR. LOTS  
 81 3 GR. LOTS  
 1371 TOTAL LOTS

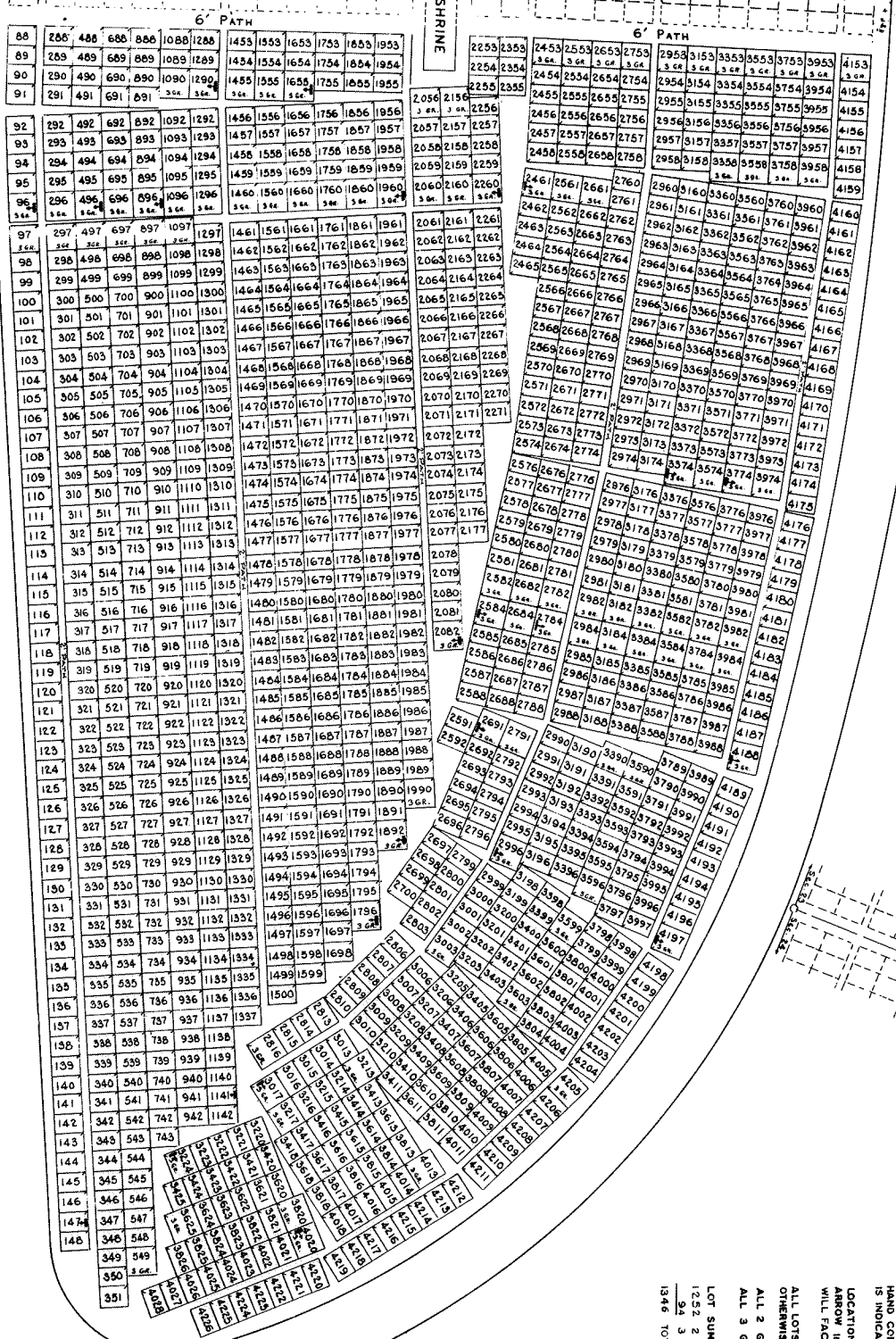

Sec. 21

**HOLY CROSS CEMETERY**  
ARRON, OHIO

WEST PART  
SECTION 22

SCALE: 1" = 20'  
JAN. 5, 1976

NOTE  
THE LOT NUMBER IS PLACED IN THE UPPER LEFT  
HAND CORNER OF LOTS AS YOU FACE THE LOTS AND  
IS INDICATED THUS  
LOCATION OF GRAVE MARKERS SHOWN THUS  
ARROW INDICATES DIRECTION GRAVE MARKERS  
WILL FACE.

LOT SUMMARY:  
1,252 2 GR. LOTS  
94 3 GR. LOTS  
1348 TOTAL LOTS

ALL LOTS ARE 2 GRAVE LOTS EXCEPT WHERE  
OTHERWISE NOTED.  
ALL 2 GRAVE LOTS ARE 6' X 9'  
ALL 3 GRAVE LOTS ARE 9' X 9'