

LOT SUMMARY  
 E PART SEC. 8  
 129 1/2 GR. LOTS  
 61 1/2 3/4 GR. LOTS  
 250 TYPICAL

LOT SUMMARY  
 SEC. 8  
 330 3/4 GR. LOTS  
 129 3/4 GR. LOTS  
 7 1/2 TYPICAL

LOCATION OF GRAVE MARKERS SHOWN THUS T  
 ARROW INDICATES DIRECTION GRAVE  
 MARKERS WILL FACE.  
 ALL LOTS ARE 2 GRAVE LOTS EXCEPT WHERE  
 OTHERWISE NOTED.  
 ALL 2 GRAVE LOTS ARE 6x9  
 ALL 3 GRAVE LOTS ARE 6x9  
 LOT NUMBERS PLACED IN THE UPPER LEFT  
 CORNER OF EACH LOT FOR THE  
 LOTS AND IS INDICATED THUS 1

REV'D 4/18/30  
 REV'D 3/28/30  
 SCALE 1"=30'  
 G.C. ADAMS  
 NOV. 1931

HOLY CROSS CEMETERY  
 AKRON, OHIO  
 SECTION 8-A &  
 E. PART SECTION 8



WATERLOO ROAD (U.S. RT. 224) 60'

CEMETERY PROP. LINE

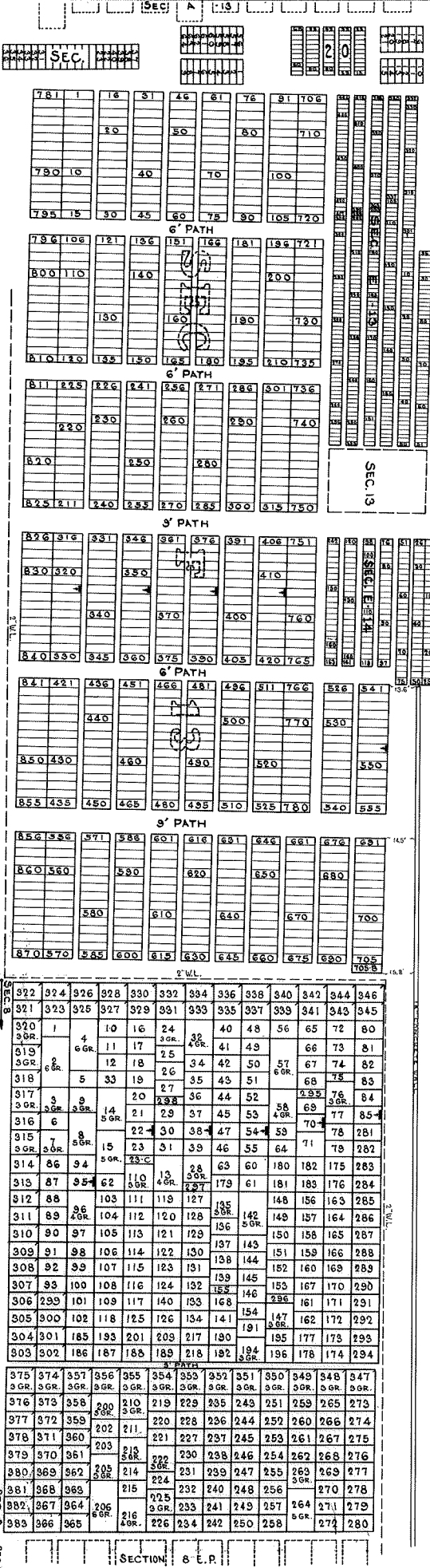

FOR LOTS 299 TO 399  
 THE LOT NUMBER IS PLACED IN THE UPPER  
 LEFT HAND CORNER OF LOTS AS YOU FACE THE  
 LOTS AND IS INDICATED THUS: [Diagram showing lot number placement]  
 LOCATION OF GRAVE MARKER IS SHOWN THUS: [Diagram showing grave marker location]  
 NARROW INDICATES DIRECTION GRAVE MARKER  
 ALL LOTS ARE 2 GRAVE LOTS EXCEPT WHERE  
 OTHERWISE NOTED.

ALL SINGLE GRAVE ARE 3'x10'  
 ALL 2 GR. LOTS ARE 6'x10'  
 ALL 3 GR. LOTS ARE 9'x10'  
 ALL 4 GR. LOTS ARE 12'x10'  
 ALL 5 GR. LOTS ARE 15'x10'  
 ALL 6 GR. LOTS ARE 18'x10'

GRAVES ARE DESIGNATED AS 'A', 'B', ETC. BEGINNING  
 FROM LOT MARKER AS SHOWN.

SEC. E-13 GR. 1 TO 870 (SINGLE GR. 5'x10')  
 SEC. E-13 GR. 1 TO 444 (SINGLE GR. 2'x4')  
 SEC. E-14 GR. 1 TO 163 (SINGLE GR. 2'x4')  
 OLD SEC. 20 GR. 1 TO 64 (SINGLE GR. 2'x4')  
 OLD SEC. 20 GR. 1 TO 64 (SINGLE GR. 2'x10')

REV'D @ 11-15-57  
 REV'D @ 2-10-57  
 REV'D @ 7-20-57

HOLY CROSS CEMETERY  
 AKRON, OHIO  
**SEC. 8 W. PART**  
 SCALE 1"=20'  
 G.C. ASBOLD  
 MARCH 1956

REDRAWN FROM OLD SEC. MAP.  
 ADDITIONAL SECS.  
 SEC. E-13  
 SEC. E-13  
 SEC. E-14  
 OLD SEC. 20

SEC. 8