

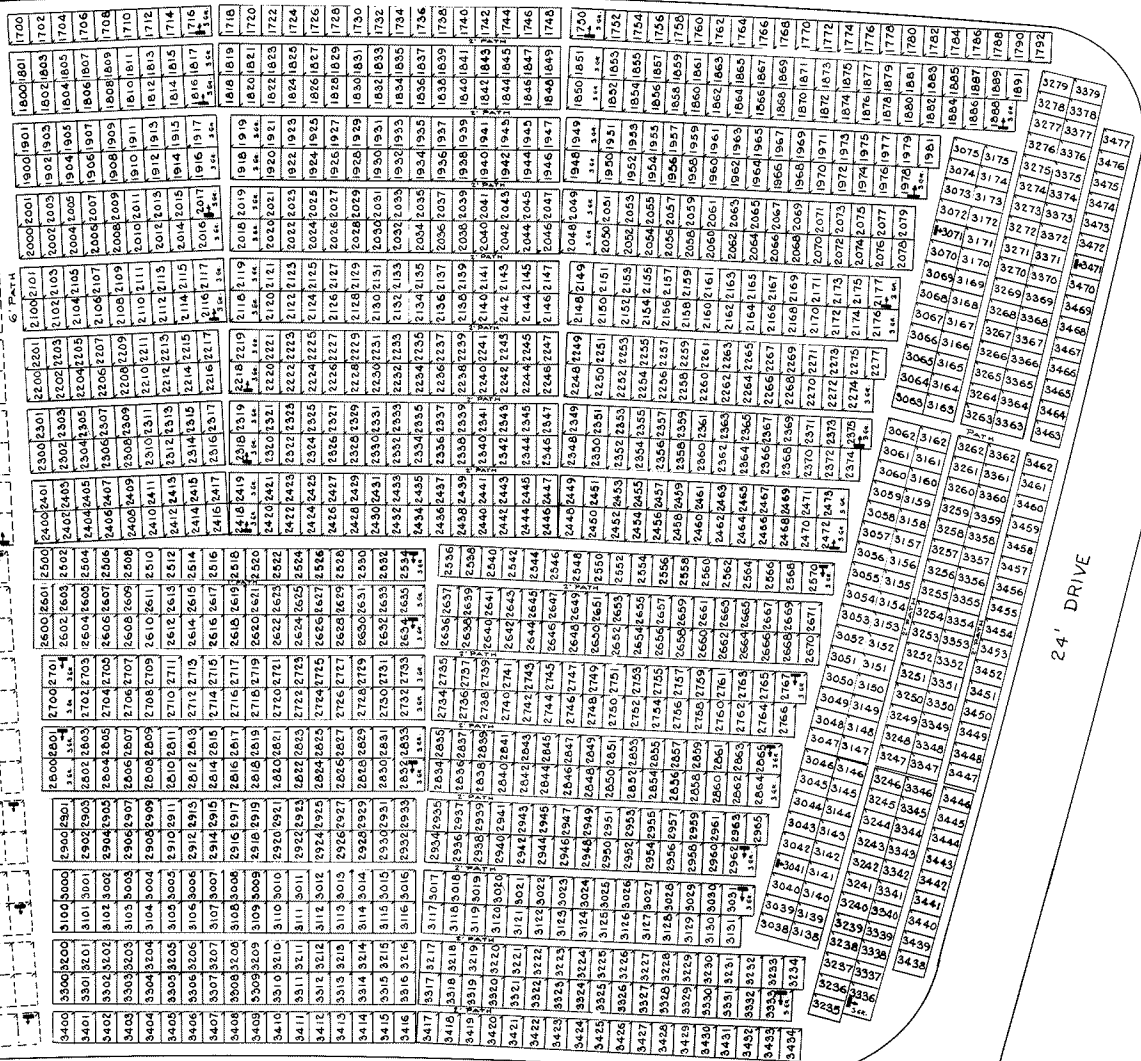

24' DRIVE

Sec. 35
WEST PART



NOTE:
THE LOT NUMBER IS PLACED IN THE UPPER
RIGHT HAND CORNER OF LOTS AS YOU FACE
THE LOT AND IS INDICATED THUS

LOCATION OF GR. MARKER SHOWN THUS 
ARROW INDICATES DIRECTION GRAVE
MARKERS WILL FACE.

ALL LOTS ARE 2 GRAVE LOTS EXCEPT
WHERE OTHERWISE NOTED.

ALL 2 GR. LOTS ARE 6' X 9'
ALL 3 GR. LOTS ARE 9' X 9'

LOT SUMMARY
1229 2 GR. LOTS
54 3 GR. LOTS
1283 TOTAL LOTS

HOLY CROSS CEMETERY
CLEVELAND, OHIO
EAST PART
SECTION 35

SCALE 1" = 20' TH. MAR. 11, 1976

24' DRIVE

24' DRIVE

24' DRIVE

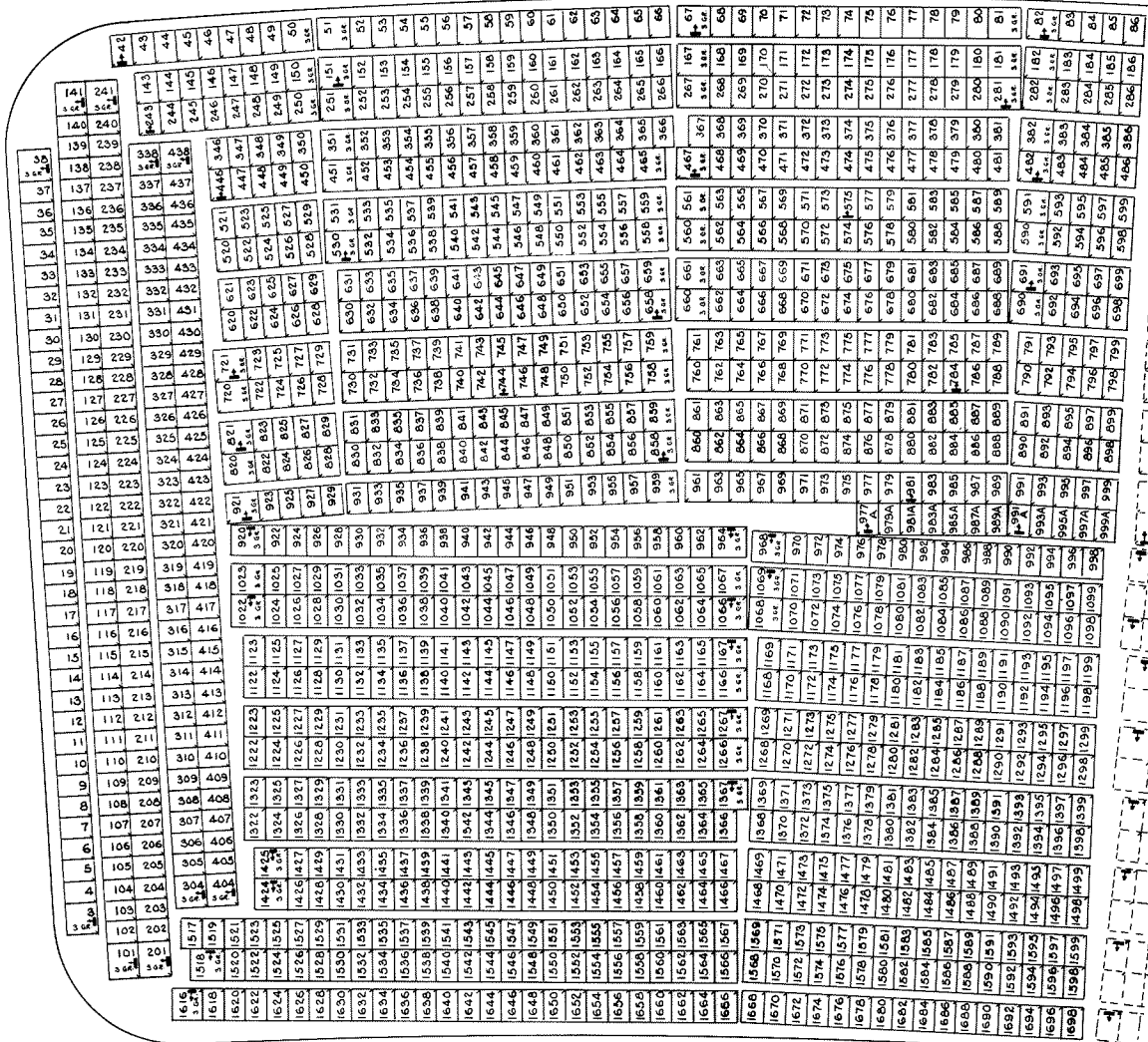

NOTE
THE LOT NUMBER IS PLACED IN THE UPPER
RIGHT HAND CORNER OF LOTS AS YOU FACE
THE LOT AND IS INDICATED THUS

LOCATION OF GR. MARKER SHOWN THUS
ARROW INDICATES DIRECTION GRAVE
MARKERS WILL FACE.

ALL LOTS ARE 2 GRAVE LOTS EXCEPT
WHERE OTHERWISE NOTED

ALL 2 GR. LOTS ARE 6' X 9'
ALL 3 GR. LOTS ARE 9' X 9'

LOT SUMMARY
1253 2 GR. LOTS
73 3 GR. LOTS
1326 TOTAL LOTS

24' DRIVE

HOLY CROSS CEMETERY
CLEVELAND, OHIO
WEST PART
SECTION 35
SCALE: 1" = 20' T.H. MAY 3, 1976