

CALVARY CEMETERY
EAST PART OF
SECTION 85

SCALE 1"=20'
 G.C. ASHCO
 FEB. 1956

THE LOT NUMBER IS PLACED IN THE UPPER RIGHT
 HAND CORNER OF EACH AS YOU FACE THE LOTS
 AND IS INDICATED THUS [7]

LOCATION OF GRAVE MARKERS SHOWN THUS [*]
 * MARKERS INDICATED DIRECTION GRAVE MARKER
 WILL FACE.

ALL LOTS ARE 2 GRAVE LOTS EXCEPT WHERE OTHERWISE NOTED.
 ALL 2 GRAVE LOTS ARE 6' X 9'
 ALL 3 GRAVE LOTS ARE 9' X 9'

CALVARY CEMETERY ASSOCIATION IS NOT
 RESPONSIBLE FOR ERRORS LEFT ON SERVICE

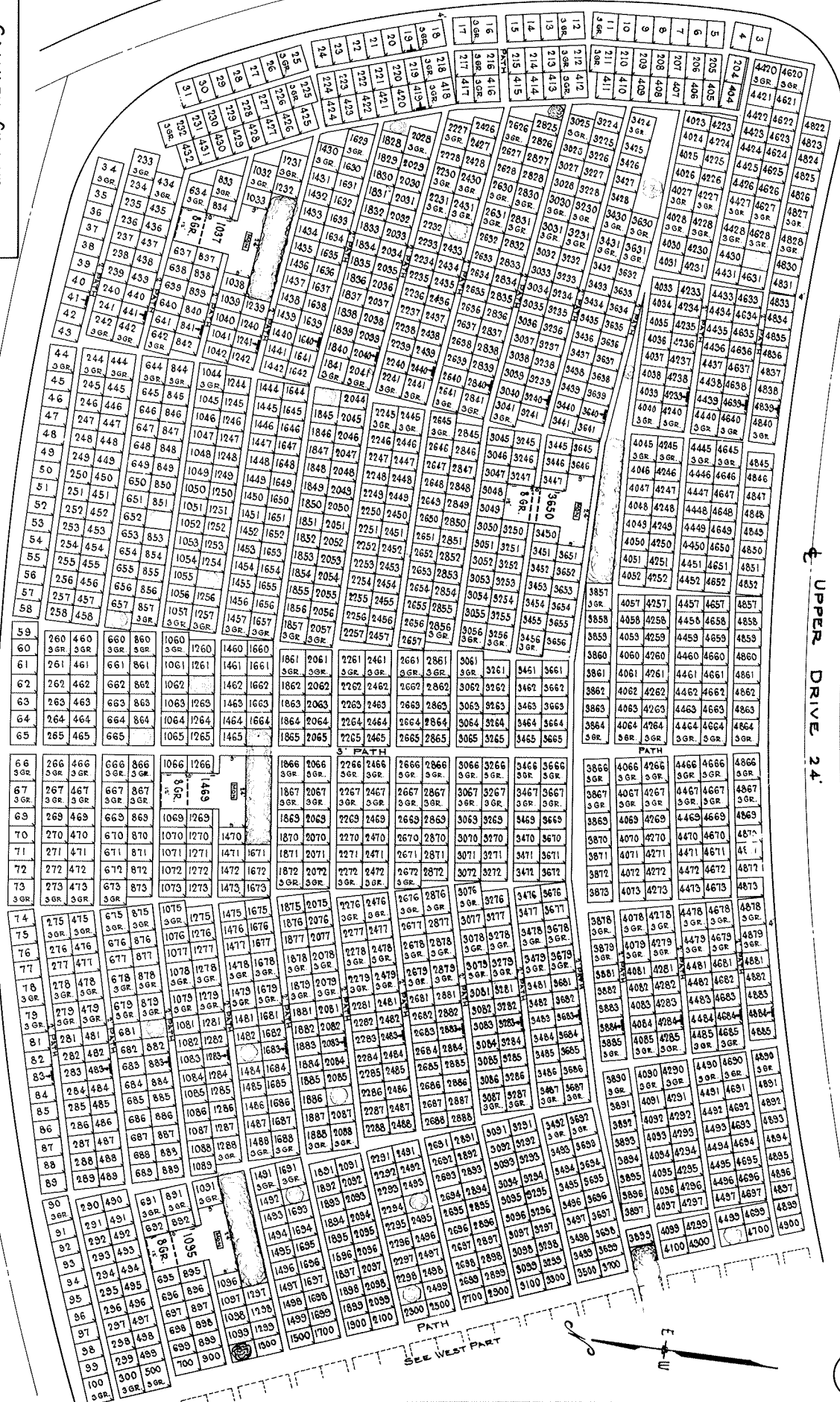

UPPER DRIVE 24

LOWER DRIVE 24

SECTION 85

SEE WEST PART



SEE EAST PART

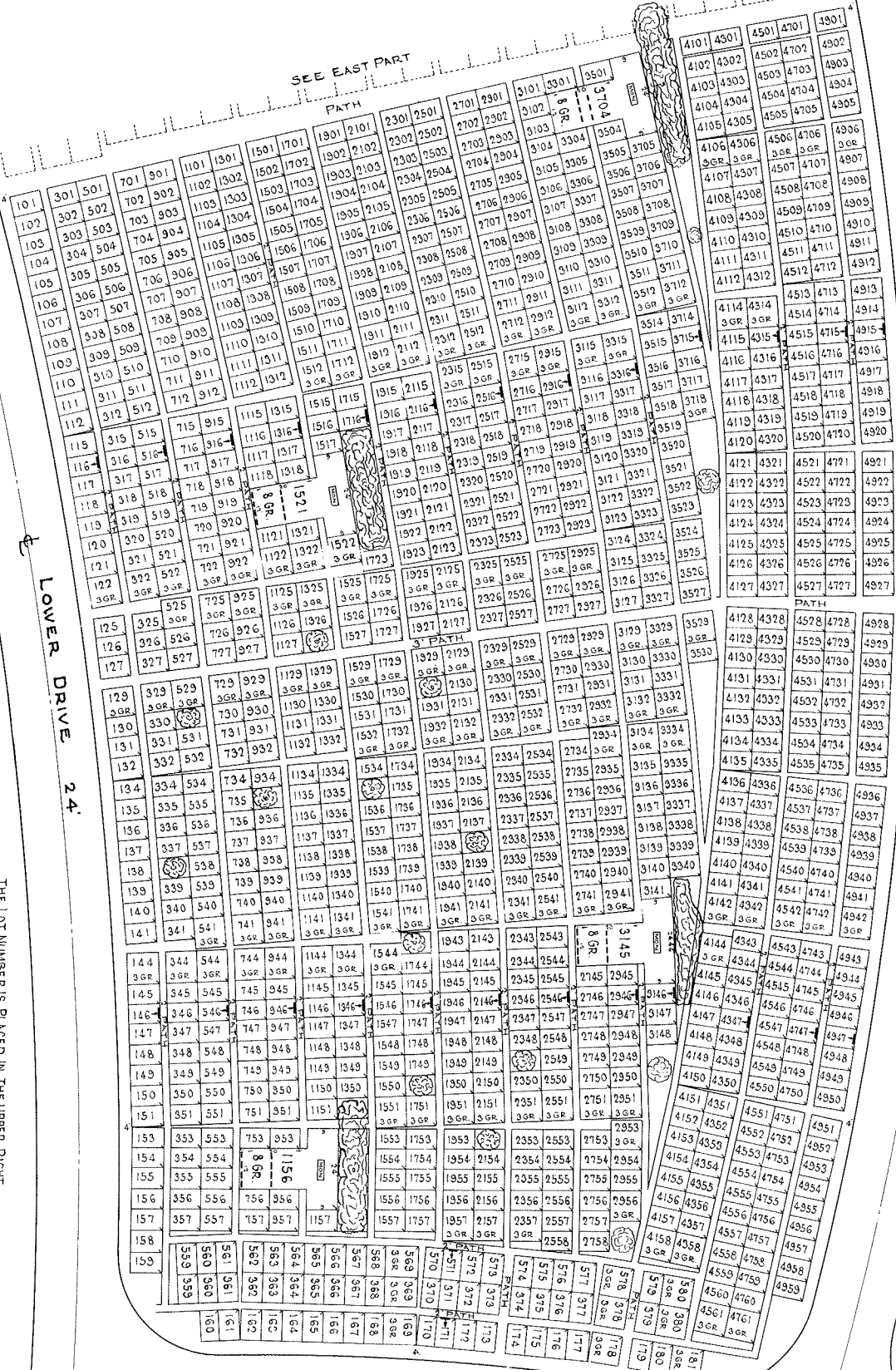

Sec 83

LOWER DRIVE 24'

UPPER DRIVE 24'

Sec 85

24' DRIVE

SEC 84

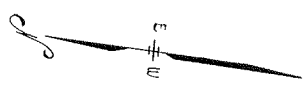

ALL PART SEC 85

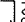
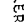
THE LOT NUMBERS IS PLACED IN THE UPPER RIGHT HAND CORNER OF LOTS AS YOU FACE THE LOTS AND IS INDICATED THUS  LOCATION OF GRAVE MARKERS SHOWN THUS  WILL FACE. ARROW INDICATES DIRECTION GRAVE MARKER

ALL LOTS ARE 2 GRAVE LOTS EXCEPT WHERE OTHERWISE NOTED.
ALL 2 GRAVE LOTS ARE 6'x9'
ALL 3 GRAVE LOTS ARE 9'x9'

CALVARY CEMETERY
WEST PART OF
SECTION 85
SCALE 1"=20' G.C.M.A.D.
FEB/1956

SEC 84



(DRIVE 24')

SEC. 91

THE LOT NUMBER IS PLACED IN THE UPPER RIGHT HAND CORNER OF LOTS AS YOU FACE THE LOT AND IS INDICATED THUS ↗ LOCATION OF GRAVE MARKERS SHOWN THUS ↖ ARROW INDICATES DIRECTION GRAVE MARKERS WILL FACE ALL LOTS ARE 2 GRAVE, EXCEPT WHERE OTHERWISE NOTED ALL 2 GRAVE LOTS ARE 6'x9' ALL 3 GRAVE LOTS ARE 9'x9'

SEC. 88

CALVARY CEMETERY
WEST PART
SECTION 86
SCALE 1"=20' E.J.M. APR. 1954

(LOWER DRIVE 24')

(UPPER DRIVE 24')

SEC 85

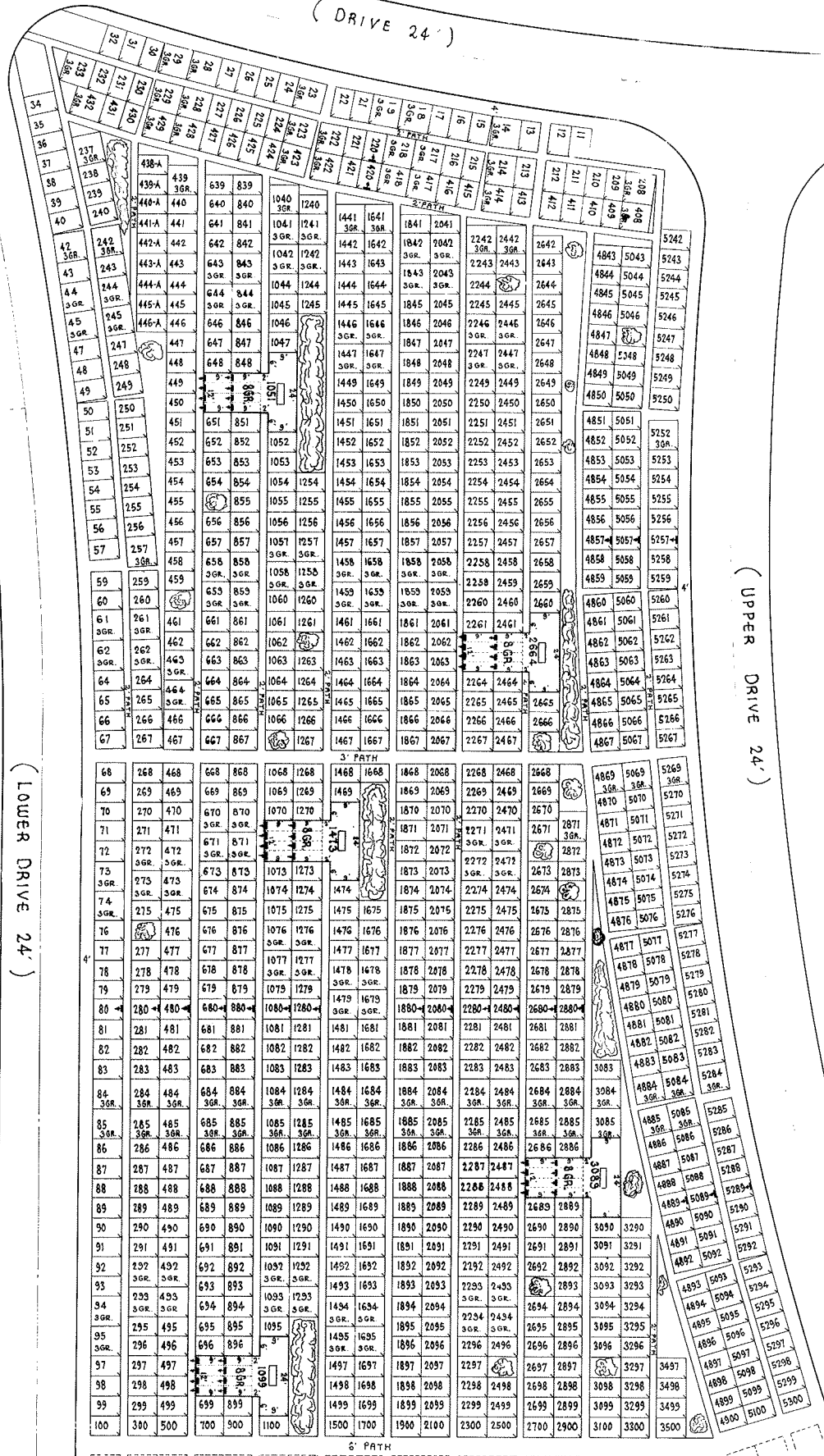

SEE EAST PART OF SEC. 86